



STARTEK

Hello Finger User Guide

Plug in Hello Finger



Select PC "settings"



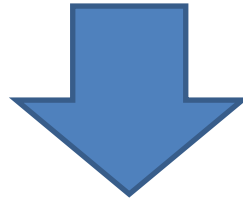

Select "accounts"



Windows Settings

Find a setting



Select "sign in options"

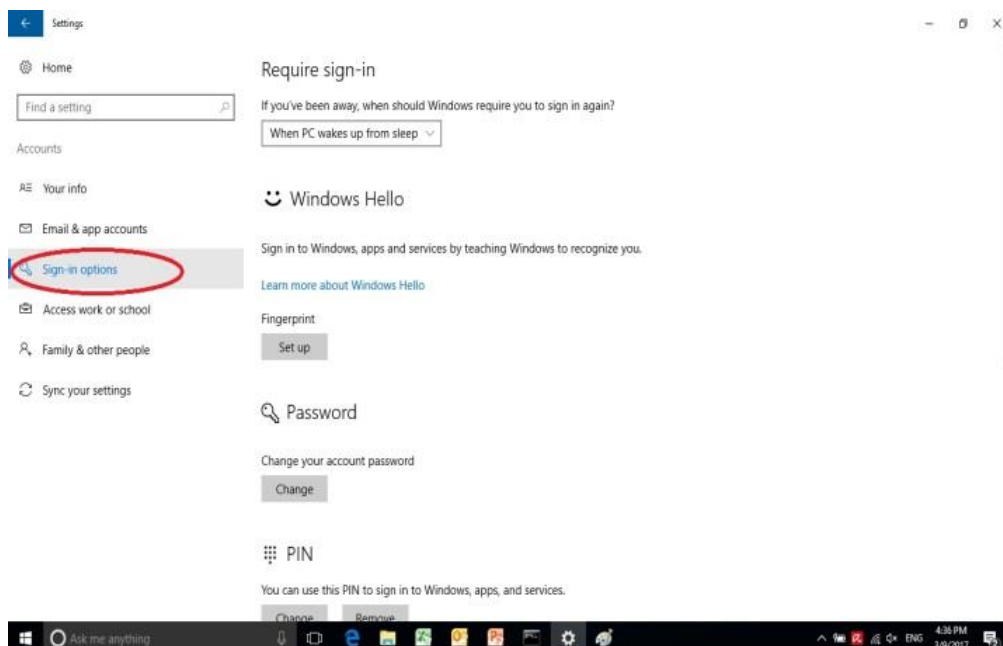

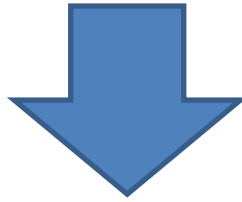

Select "Fingerprint set up"

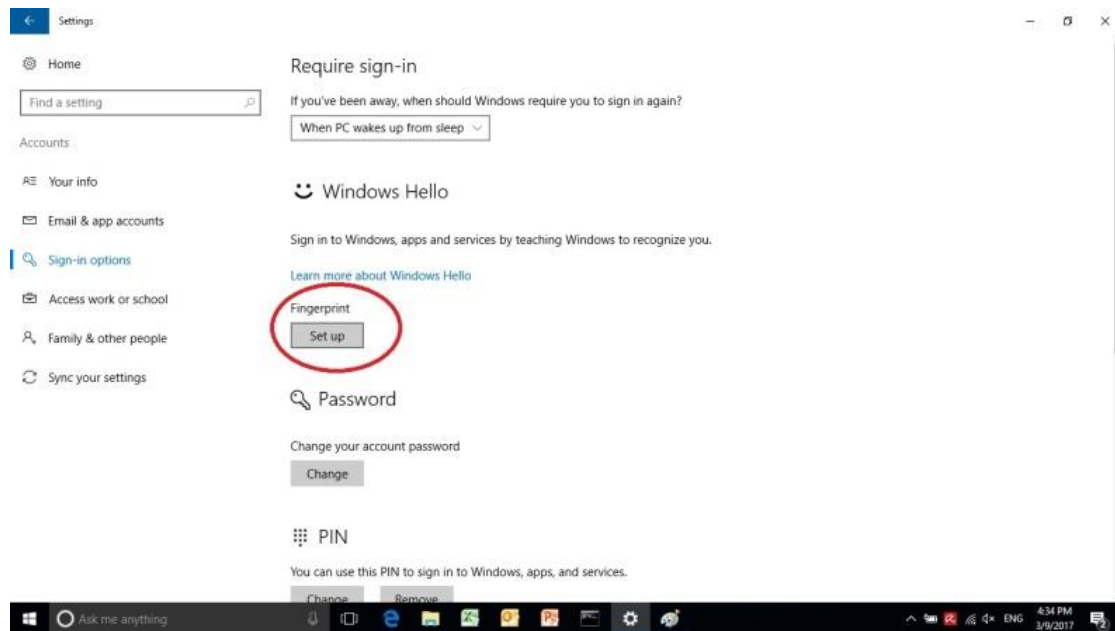

Get Started

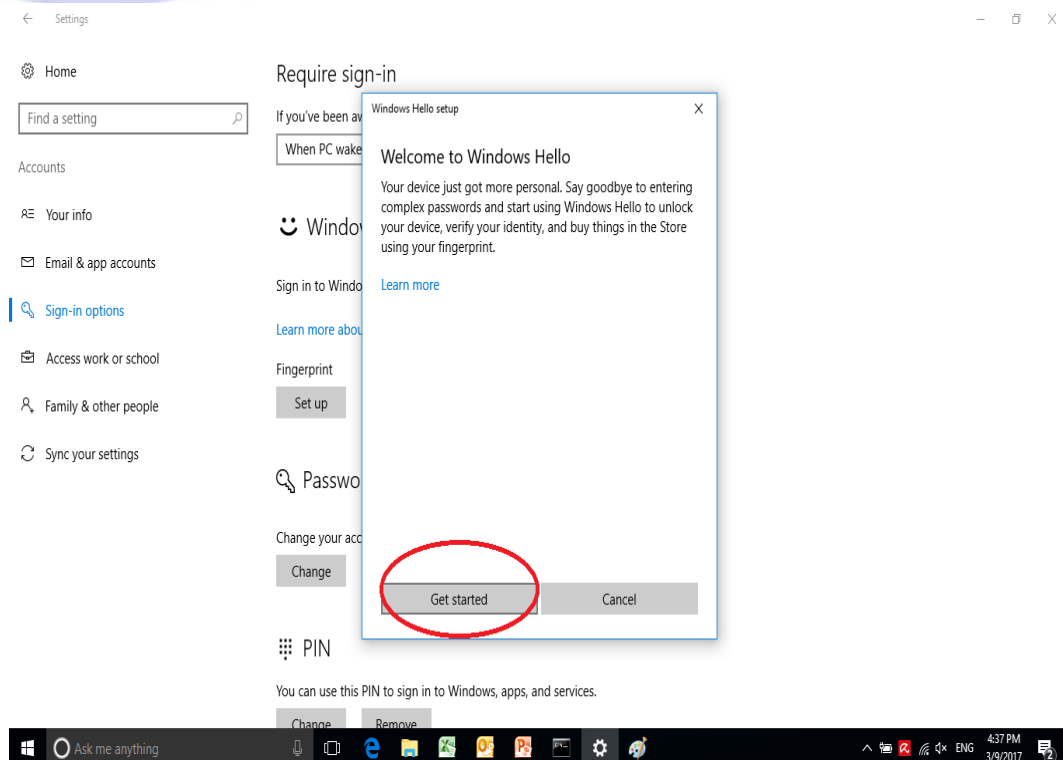

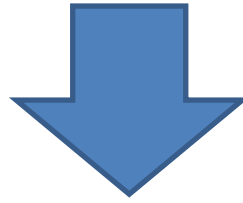

Touch Hello Finger Sensor

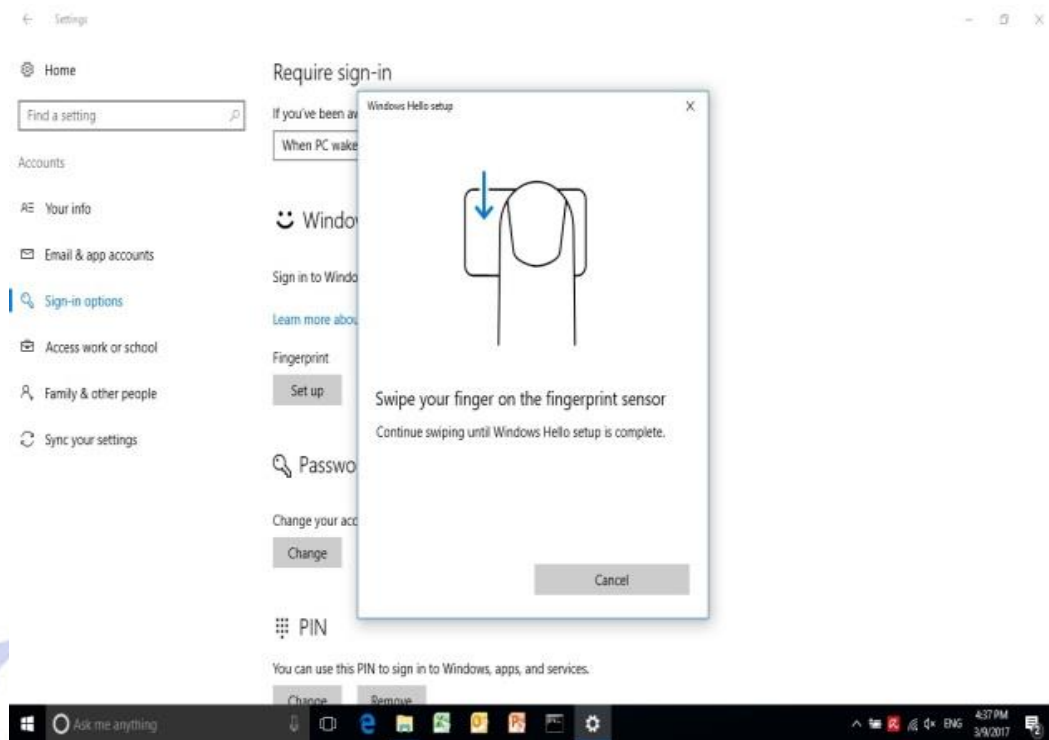

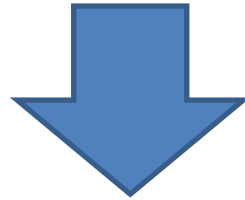

Touch sensor repeatedly

After adding in another fingerprint , you are ready for windows hello

